

150mm HURRICANE E-DUCT

DATE: 17 December 1999

REVISED: 29 July 2008

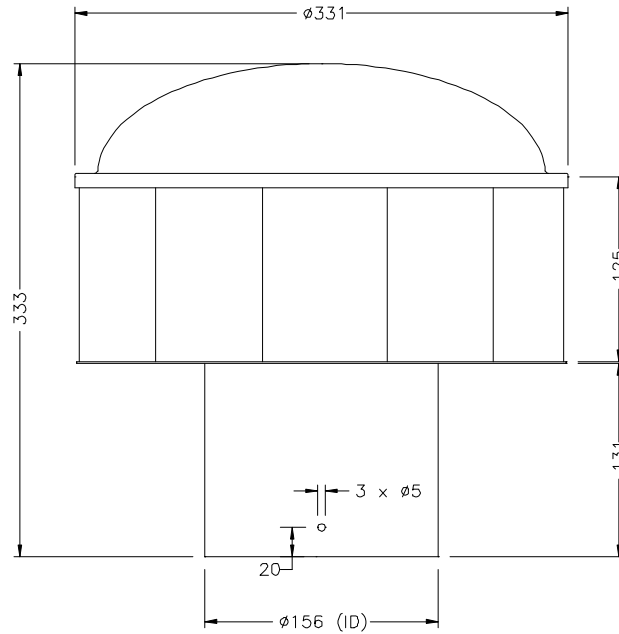

SPECIFICATION:

MATERIAL:	Turbine: Aluminium 5005
	Dome: Aluminium 1200
	Brackets & Throat: Stainless Steel 304
	Shaft: Stainless Steel 303
	Bearing Holder & Arms: Nylon 6 Glass Filled
	Rivets: Stainless Steel STST 302
	Screws & nuts: Stainless Steel 304
FINISH:	Powdercoated inside and out with polyester powder
WEIGHT:	2.3kg
TOLERANCES:	Size +/- 2mm
	Weight +/-0.2kg

225mm HURRICANE E-DUCT

DATE: 17 December 1999

REVISED: 29 July 2008

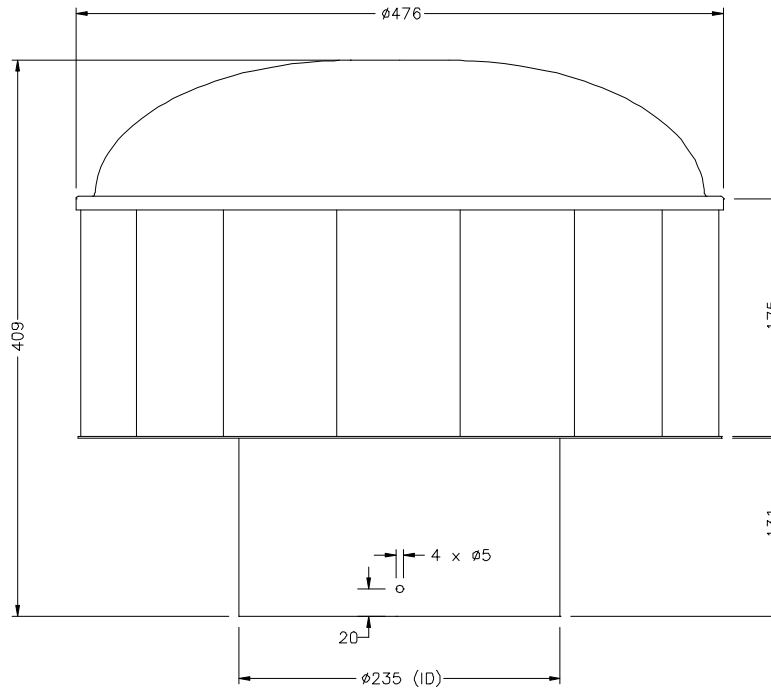

SPECIFICATION:

MATERIAL:	Turbine: Aluminium 5005
	Dome: Aluminium 1200
	Brackets & Throat: Stainless Steel 304
	Shaft: Stainless Steel 303
	Bearing Holder & Arms: Nylon 6 Glass Filled
	Rivets: Stainless Steel STST 302
	Screws & nuts: Stainless Steel 304
FINISH:	Powdercoated inside and out with polyester powder
WEIGHT:	4.3kg
TOLERANCES:	Size +/- 2mm
	Weight +/-0.2kg

300mm HURRICANE E-DUCT

DATE: 17 December 1999

REVISED: 29 July 2008

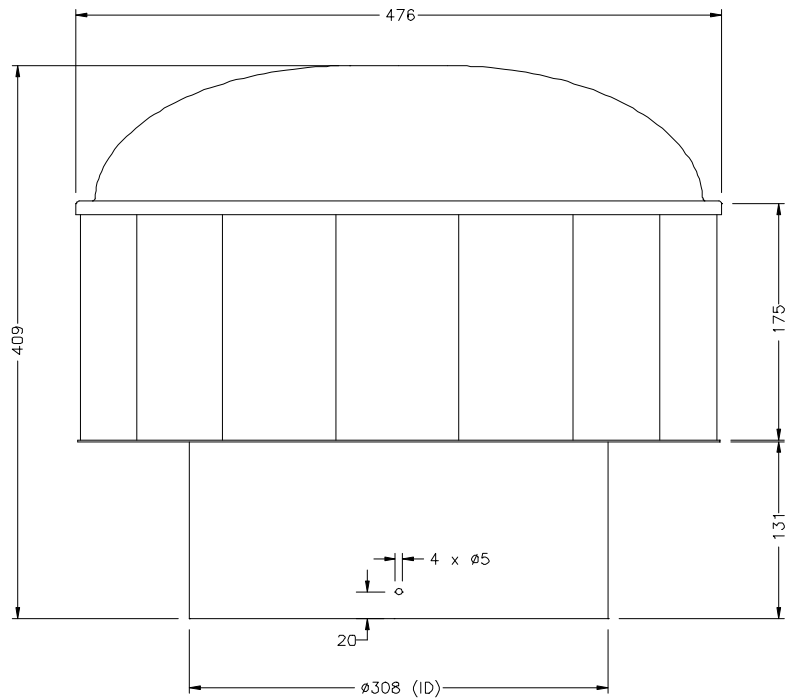

SPECIFICATION:

MATERIAL:	Turbine: Aluminium 5005
	Dome: Aluminium 1200
	Brackets & Throat: Stainless Steel 304
	Shaft: Stainless Steel 303
	Bearing Holder & Arms: Nylon 6 Glass Filled
	Rivets: Stainless Steel STST 302
	Screws & nuts: Stainless Steel 304
FINISH:	Powdercoated inside and out with polyester powder
WEIGHT:	4.5kg
TOLERANCES:	Size +/- 2mm
	Weight +/-0.2kg