



MAX FLOW RATE  
EQUIVALENT OF UP TO  
SIX WIND DRIVEN VENTS

# AiroMatic®

## Clear Roof Top Ventilator Powered by Air iQ

AiroMatic® powered by Air iQ is a high-performance, smart ventilation system for the removal of heat load and prevention of damaging condensation in the roof space. The clear dome allows light into the roof area for improved visibility and the reduction of unwanted vermin.

### Heat Reduction

Preset to a powerful fixed speed for continuous and high performance ventilation, AiroMatic also includes a variable speed option that automatically detects and removes heat and humidity from the roof space.

### Condensation Management

AiroMatic removes moisture from the roof space to greatly minimise risk of damaging condensation and mould growth.

### Humidity Detection

Bradford Air iQ smart box automatically detects heat and humidity to protect the home when it matters most.\*



Two eave vents are recommended for each AiroMatic for improved air flow<sup>^</sup>



Bradford Ventilation is a proud partner of Sensitive Choice®

#### Features:

- Sleek design with clear dome made with high quality UV stable polymer
- Maximum flow rate of 647m<sup>3</sup>/hr
- Powerful fixed and variable speed options available for high performance ventilation
- Can be fitted with ducting and a ceiling grille in specific rooms in the home<sup>#</sup>
- Bradford Air iQ smart box automatically detects and removes heat and humidity\*
- Polymer construction in four popular colours
- High efficiency 24V DC motor

#### Benefits:

- Allows natural light into the roof space, deterring unwanted pests
- Effective ventilation in most climates
- Removes heat load in warm months and reduces condensation in the roof space in cool months
- With ducting and a ceiling grille, moisture can be removed from rooms like bathrooms and laundries
- Complements most metal or tile roofs
- Quiet operation, low running costs and reduced energy usage
- Improves air quality

<sup>^</sup> If using AiroMatic to comply with NCC2019 Performance Solution additional eave vents are required. For more information on how to comply with Bradford's NCC2019 Performance Solution see the Product Manual.

\*Operating mode preset to fixed speed for NCC2019 compliance. For more information on how to activate alternate settings, see the Product Manual at [bradfordventilation.com.au](http://bradfordventilation.com.au)

<sup>#</sup>Ducting and ceiling grille not supplied with AiroMatic.

<sup>†</sup>One year warranty on power pack.

# Specifications

AiroMatic	
Flow rate	Up to 647 m <sup>3</sup> /hr
Speeds*	Preset fixed speed or four alternate speed settings available
Power supply output and fan motor	24V DC
Dome and housing	UV stable polymer

Colours	Material Code	Carton Size (L x W x H)
Headland®	112153	520 x 235 x 520 mm
Night Sky®	112154	520 x 235 x 520 mm
Surfmist®	112155	520 x 235 x 520 mm
Woodland Grey®	112156	520 x 235 x 520 mm

\*Operating mode preset to fixed speed for NCC2019 compliance. For more information on how to activate alternate settings see the Product Manual at [bradfordventilation.com.au](http://bradfordventilation.com.au)

## Installation guidelines<sup>^</sup>

### Tiled Roof

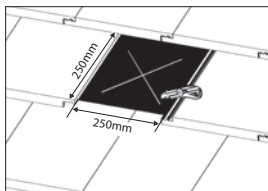

#### Step 1

Remove one tile three rows down from ridge cap. Cut and fold back sarking if required.

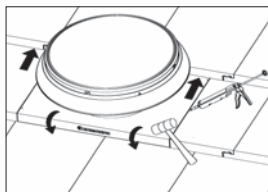

#### Step 2

Slide the flashing under the tiles above the opening and fold the bottom edge to seal against lower tiles. Apply a bead of silicone under the side and front edges of the flashing for a weatherproof installation.

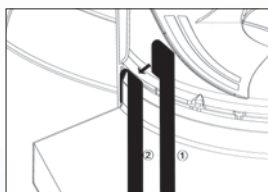

#### Step 3

From within the roof space, fit the fixing strap by hooking it between the flashing up stand and the outer housing.

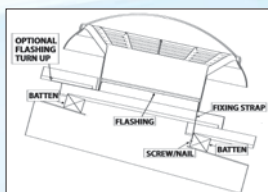

#### Step 4

Screw or nail the fixing strap to the bottom batten.

### Metal Roof

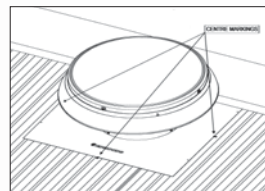

#### Step 1

Position vent appropriately and slip the top edge of the flashing under the ridge capping. Mark the position of the vent. Back flashing must be used if positioned lower down the roof.

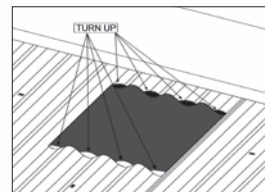

#### Step 2

Using the marks, cut a 250mm square opening.

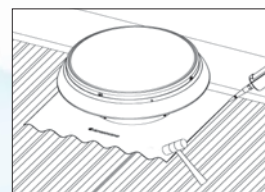

#### Step 3

Slip the top of the flashing under the ridge cap and dress the flashing into the metal sheet corrugations. Run a bead of silicone underneath the three exposed sides.

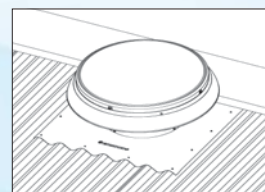

#### Step 4

Secure the flashing to the metal sheeting with Tek screws or sealed rivets along the 3 exposed edges of the flashing.

<sup>^</sup>If installing AiroMatic in accordance with the NCC2019 Performance Solution, it must be installed within 900mm of the ridge line measured vertically. See the Product Manual for more information.

Detailed warranties, technical data sheets and installation instructions available at [bradfordventilation.com.au](http://bradfordventilation.com.au)

For more information, call **1300 858 674**

CSR Bradford

Locked Bag 1345 North Ryde BC NSW 1670

CSR Bradford is a business division of CSR Building Products Limited ABN 55 008 631 356.

The COLORBOND® steel colour swatches and images shown in this brochure have been reproduced to represent actual product colours as accurately as possible. However, we recommend checking your chosen colour against an actual sample of the product before purchasing as varying light conditions and limitations of the printing process may affect colour tones. COLORBOND®, BlueScope,™ and ® Colour names are registered trademarks of BlueScope Steel Limited.